

■ Packaging

(1) Tape packaging dimensions

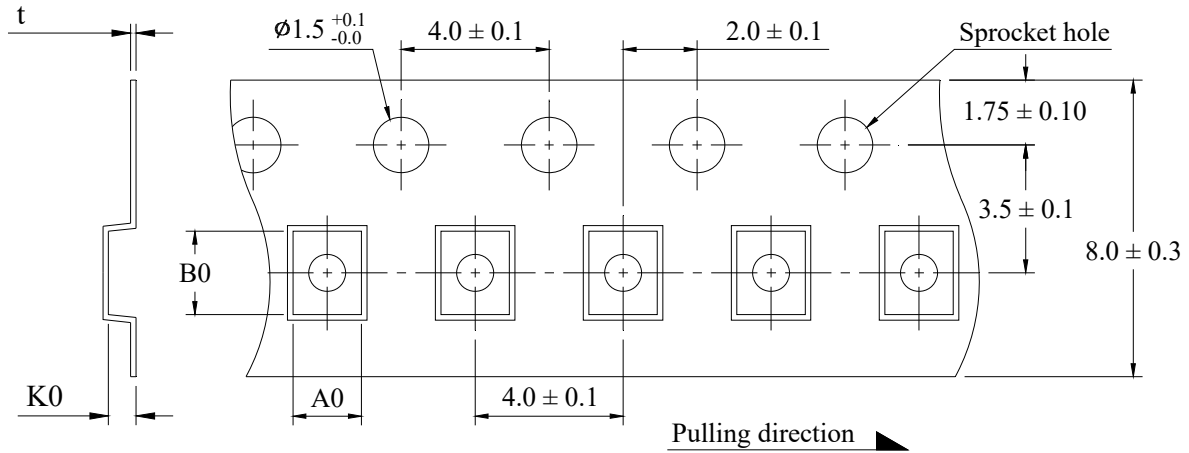

| Dimensions Code (mm) | | | | UNITS/REEL |
|----------------------|-----------------|-----------------|-----------------|------------|
| A0 | B0 | K0 | t | |
| 1.85 ± 0.10 | 2.25 ± 0.10 | 1.35 ± 0.10 | 0.25 ± 0.05 | 2,000 |

(2) Tape Direction

The direction shall be seen from the top cover tape side.

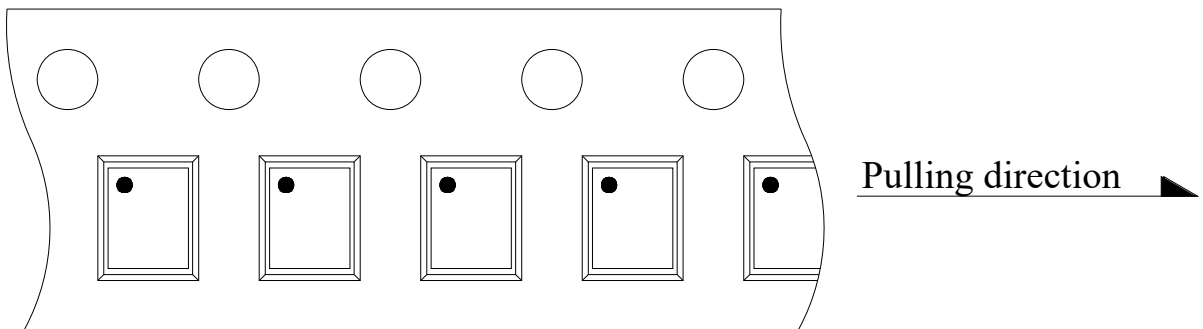

(3) Reel dimensions

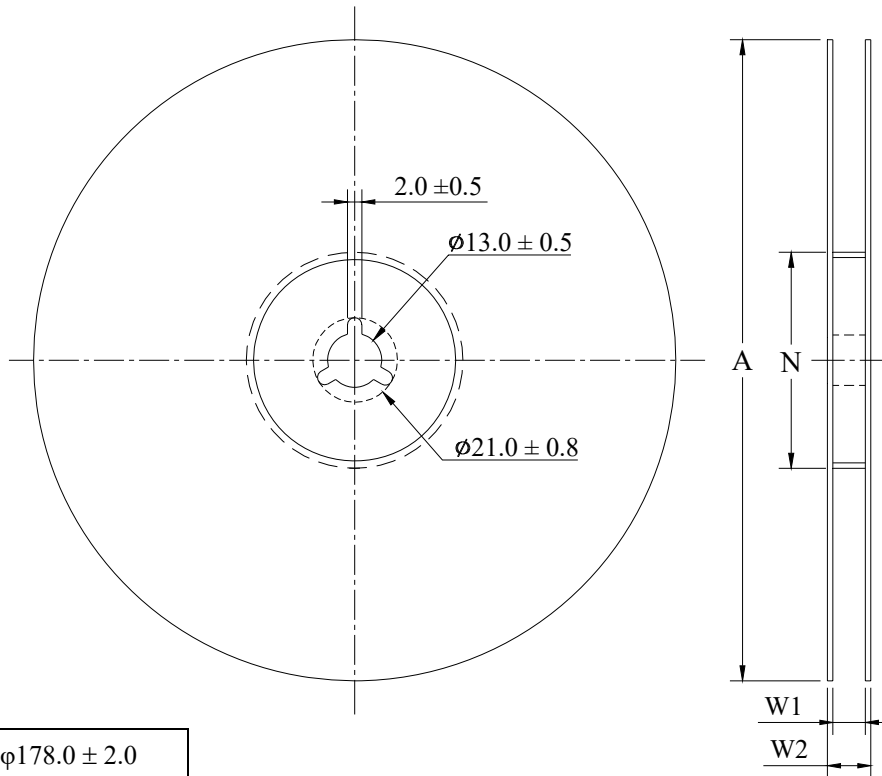

| | |
|----|----------------------|
| A | $\phi 178.0 \pm 2.0$ |
| N | $\phi 60.0 \pm 2.0$ |
| W1 | 9.0 ± 0.3 |
| W2 | 11.4 ± 1.0 |

Unit : mm

(4) Peel force of top cover tape

The peel speed shall be about 300 mm/minute.

The peel force of top cover tape shall be between 0.1 to 0.7N.

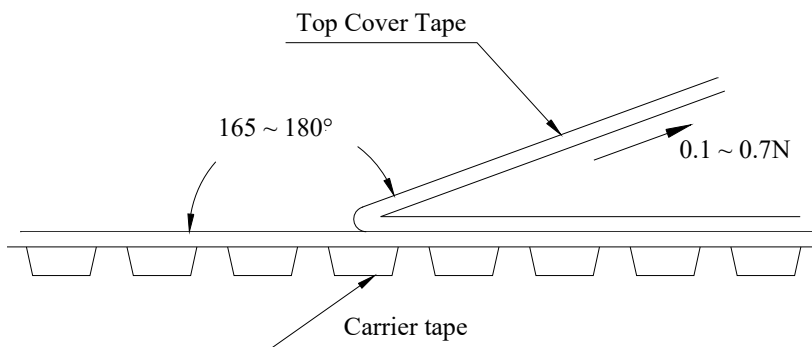

■ Reflow Profile

Power Choke Coil Type

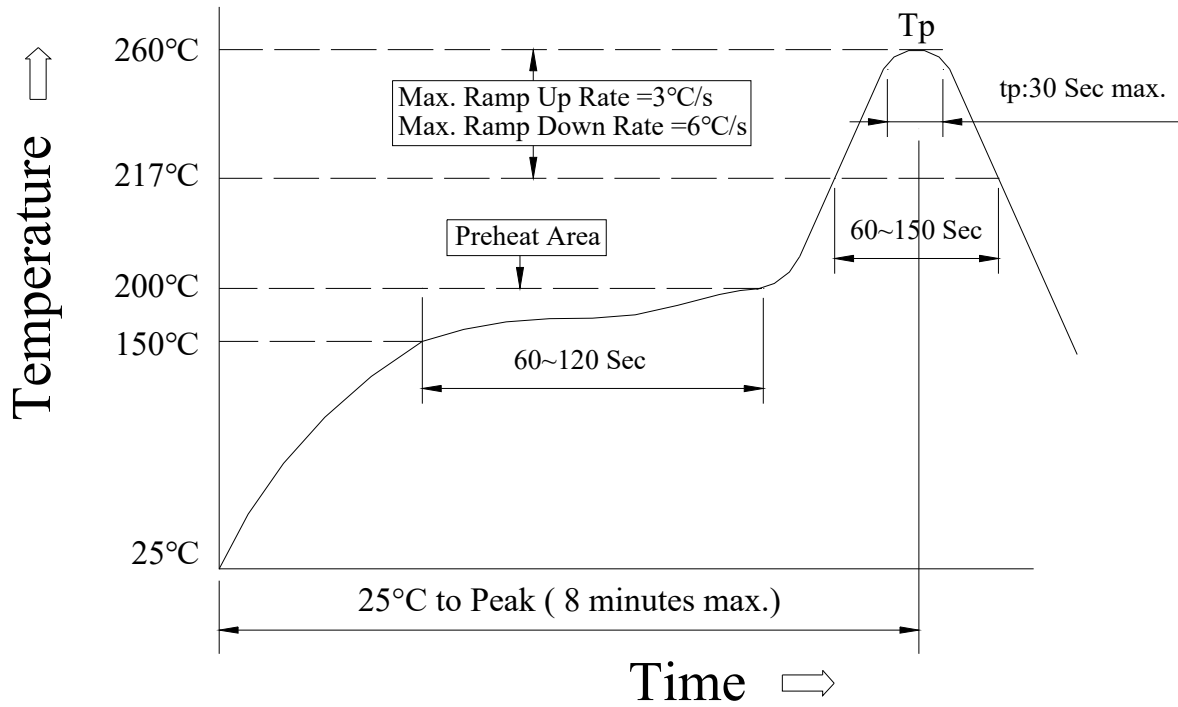

(1) Reflow Soldering Method :

| | | |
|-------------------------------|----------------|-----------------------|
| Reflow Soldering | Tp:255~260°C | Max.30 seconds (tp) |
| | 217°C | 60~150 seconds |
| Pre-Heat | 150 ~ 200°C | 60~120 seconds |
| Time 25°C to peak temperature | 8 minutes max. | |

(2) Soldering iron Method : 350 ± 5°C max.3 seconds